

**TITAN HV**  
EQUIPPING  
BUILDERS TO  
SUCCEED



**TITAN**  
formwork systems



# TITAN FORMWORK SYSTEMS

---

## What We Provide

- » Comprehensive project and pricing analysis prior to the job start.
- » Accurate engineered and color-coded shop drawings, complete with P.E. stamp.
- » On-site training to promote safety and efficiency.

# TITAN HV

Our handset modular drophead system features lightweight aluminum beams capable of shoring up to 24'7" (7.5m)\* tall and framing up to 16" (400 mm) thick slabs without supplemental shores.

\*Heights above 21'4" (6.5 m) achieved with 1 m extension.

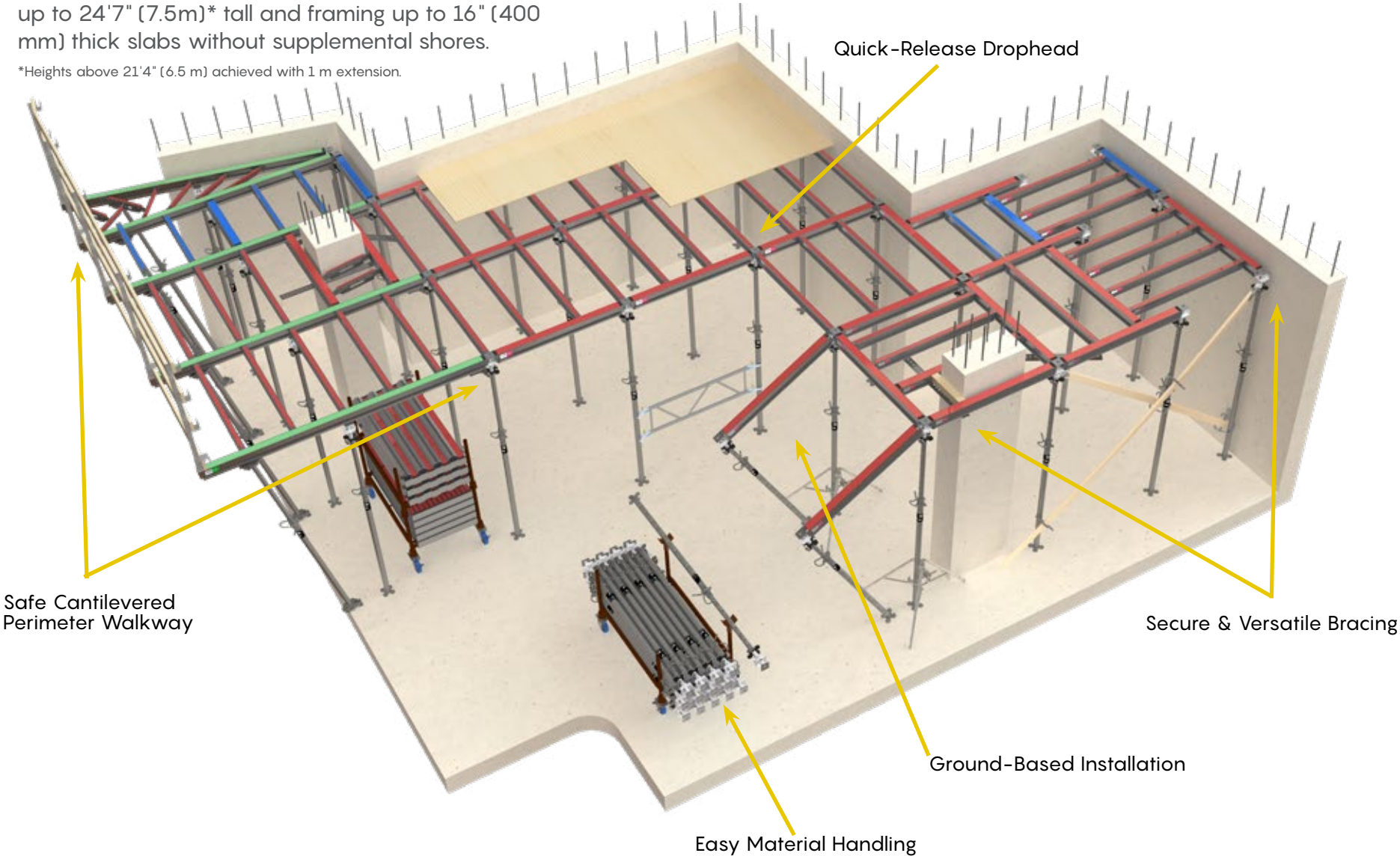

Safe Cantilevered Perimeter Walkway

Quick-Release Drophead

Secure & Versatile Bracing

Ground-Based Installation

Easy Material Handling

# SHORES & BEAMS

The TITAN HV system is up to 45% more productive than the standard 20k shoring. The lightweight aluminum members are easy to install and minimize crane requirements. A two-person crew is fully capable of installing an entire deck. The interlocking members eliminate cutting or lapping, and there is no costly make-up or assembly required.

## Main Beams

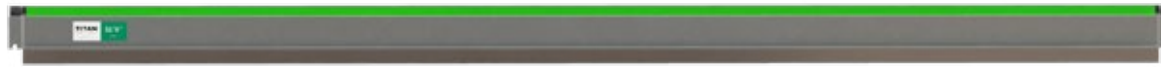

11'6" HV MB - (3.5m) / 70.1lb



7'7" HV MB - (2.3m) / 46lb



5'7" HV MB - (1.7m) / 34lb



3'9" HV MB - (1.15m) / 22.8lb

## Secondary Beams



5'7" HV SB - (1.7m) / 13.7lb



3'9" HV SB - (1.15m) / 9.5lb



4'5" - 6'7" (1.3m - 2m) / 35.9lb w/ Drophead

#1.75



5'7" - 9'0" (1.7m - 2.75m) / 42.2lb w/ Drophead

#2.5



7'4" - 12'4" (2.2m - 3.75m) / 55.2lb w/ Drophead

#3.5



9'7" - 14'4" (2.9m - 4.35m) / 86.9lb w/ Drophead

#4



10'9" - 18'10" (3.3m - 5.75m) / 97.3lb w/ Drophead

#5.5



15'2" - 21'4" (4.6m - 6.5m) / 91lb w/ Drophead

XL 625



7'4" - 12'4" (2.2m - 3.8m) / 75 lb w/ Drophead

XL 350

# DELIVERY

TITAN's balanced loads save time and money by eliminating double handling and excess equipment storage. Each truck comes equipped with everything you need to get started, including easily verifiable field counts and stacking standards. Simply unload and get to work.



## QUALITY ASSURANCE

Each barella is fully inspected to ensure both quality and safety.



## SIMPLE HANDLING

Wheels are provided to allow all carts to be quickly and easily transported on the job site.



# INSTALLATION

- 1 Secure the first few shores with tripods and hang the Main Beams from the Dropheads.
- 2 Raise the Main Beam with the Shore/Drophead into position.
- 3 Begin installing the Secondary Beams.
- 4 Install Column Lock and other required braces.
- 5 Once sufficient framing is secured, plywood can be installed to achieve a pour-ready system.

# REMOVAL

- A Release Dropheads with a hammer. These quick-release Dropheads allow for removal of framing members as early as one day after the pour.
- B Remove Main Beams and Secondary Beams and place them in the barellas. These beams can be cycled to floors above, requiring less equipment overall.
- C Shores can be removed once a stripping release is obtained and reset as a reshore.

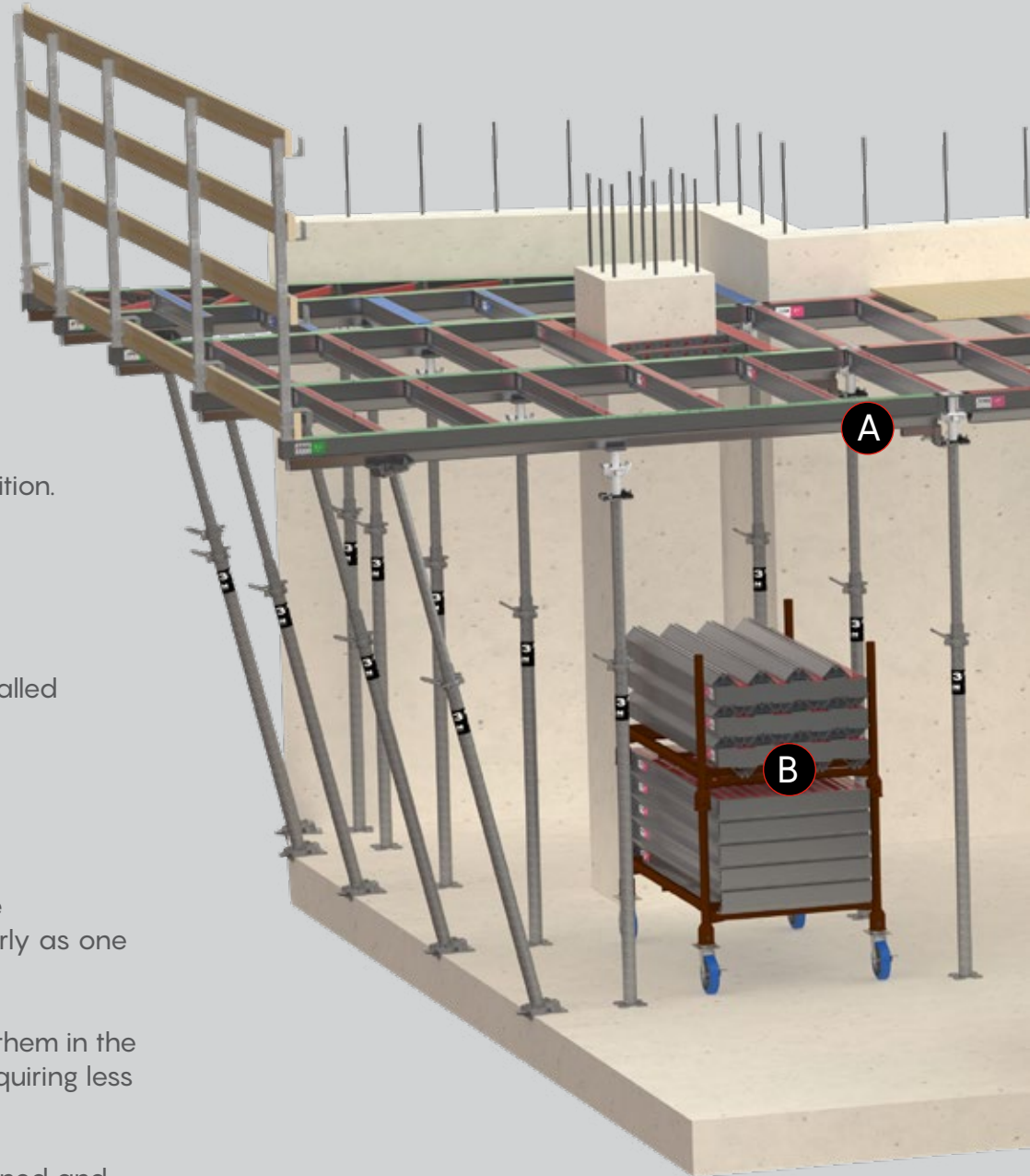

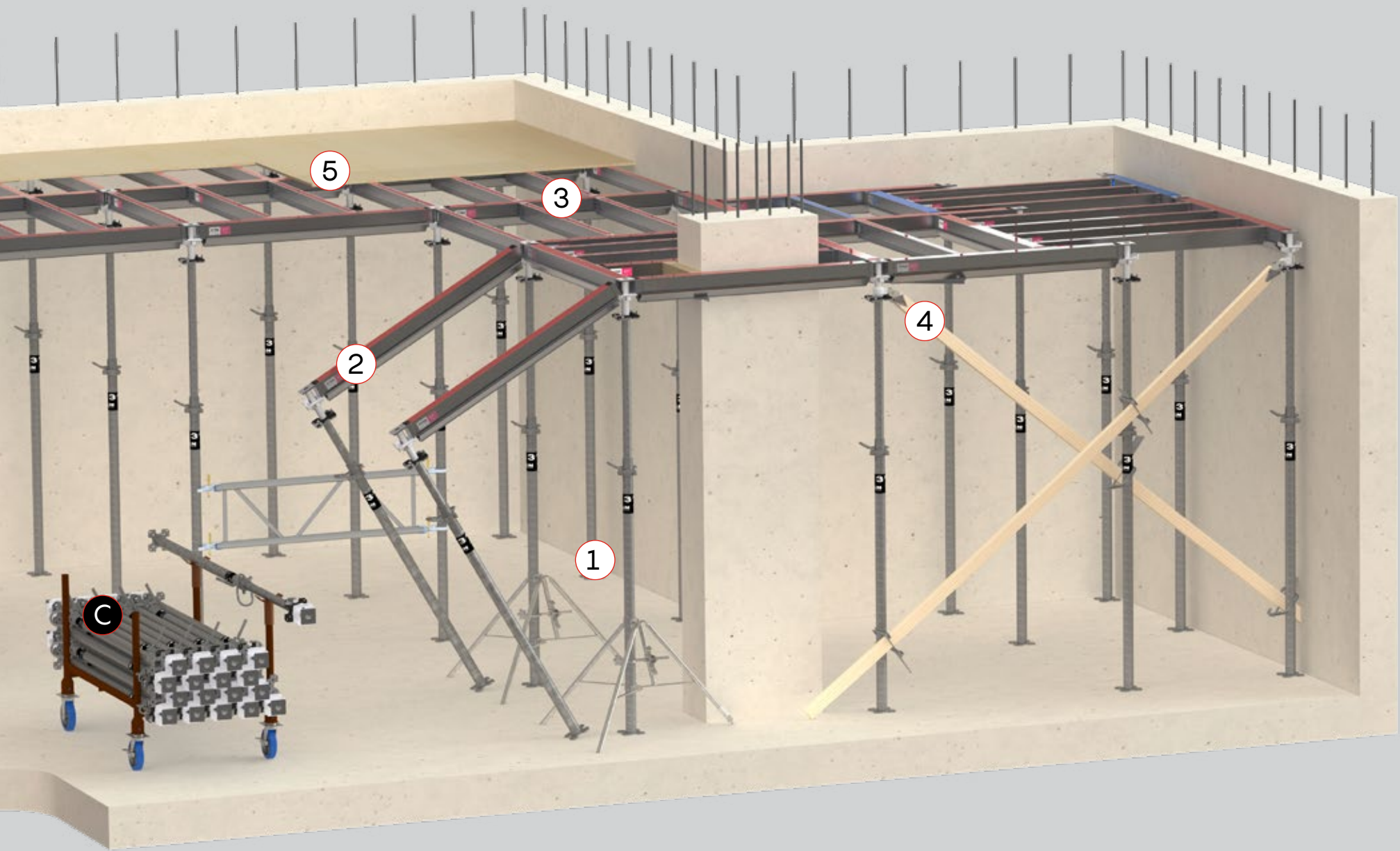



3.5

3.5

TITAN

formwork systems

starformwork.com

tel: www.titanet.com



# SYSTEM OVERVIEW

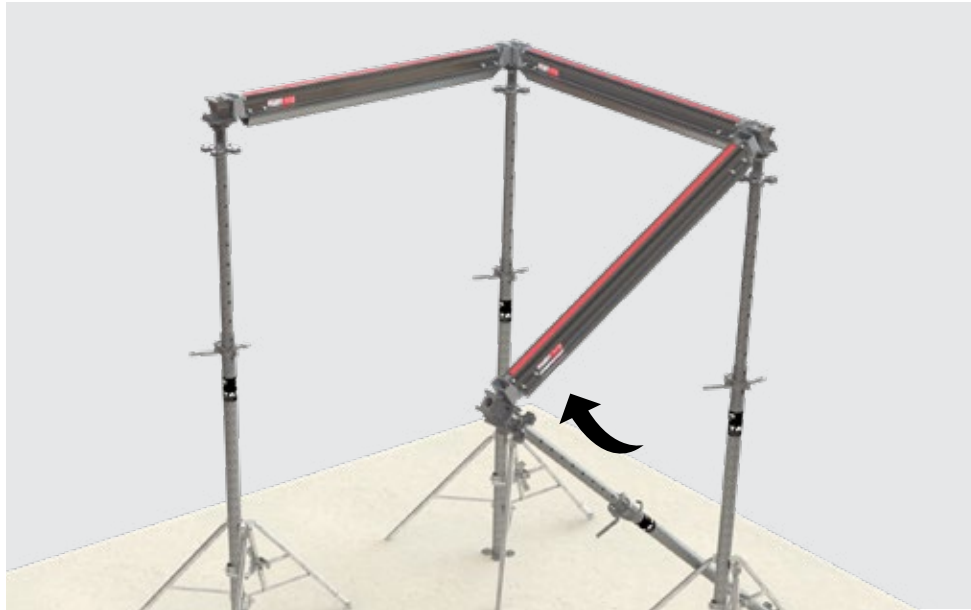

## Ground-Based Installation

Eliminates fall hazards and requires as few as two workers to install.

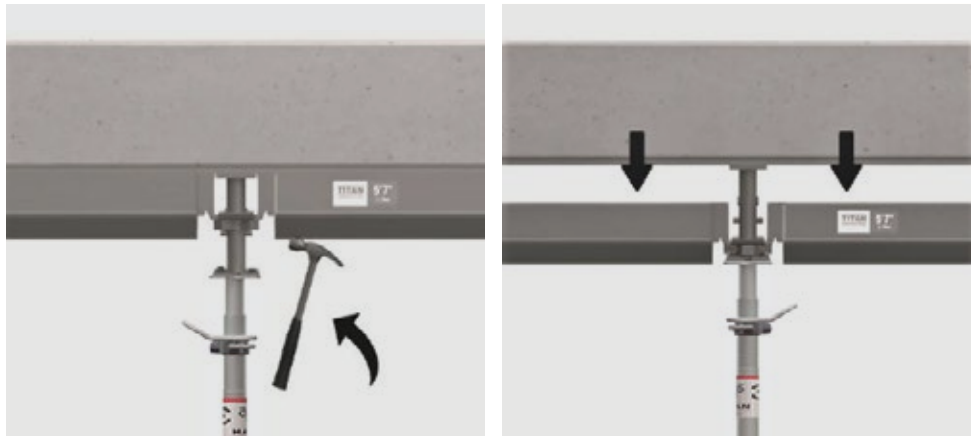

## Quick-Release Drophead

Allows for safe and early removal of Main and Secondary Beams.



## Safe Cantilevered Perimeter Walkway

Easy drop-in 60" (1.5 m) Guardrail Posts provide increased safety, while the TITAN Safety Catch prevents uplift and the TITAN Positioner provides a positive connection between the shore and the beam. A pair of aluminum T-Shoes can extend the cantilever an additional 3' (0.9 m).

# BRACING & STABILITY



## Column Lock

Has a lateral capacity of 4,000 lbs without reliance on x-braces; one aluminum Column Lock pair replaces up to eleven 3-post x-braces



## Drophead Clamp

Allows one ground-based worker to install braces to shores up to 14' without a ladder or scissor lift

## Universal Wedge Clamp

"One-size-fits-all" tool designed to brace 2x4's to all TITAN shores and other shoring systems



## Universal Tripod

Ensures lateral stability while erecting shores, even on sloped surfaces using the adjustable leg

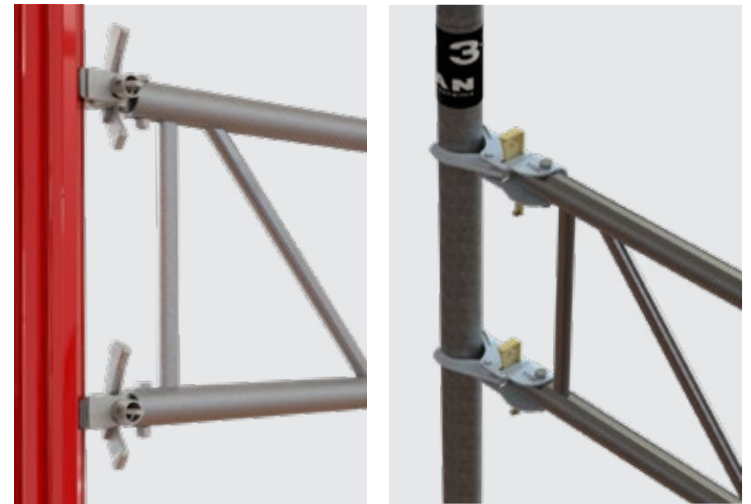

## XL & HV Ledger

Used for stability while erecting the first few posts and can be installed quickly by just one worker

# SPECIAL CONDITIONS

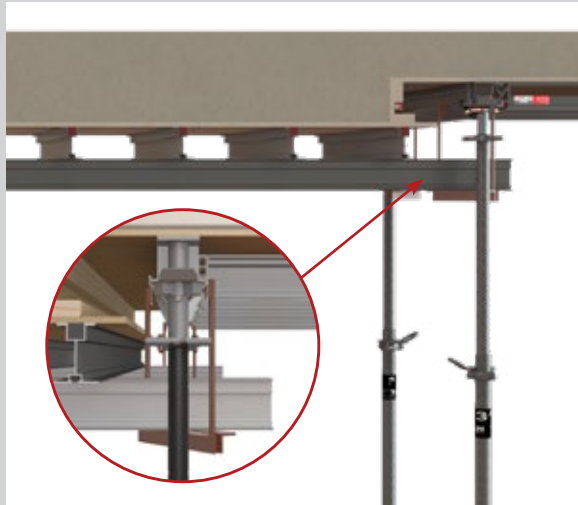

## Drop Panels

Can efficiently be hung from slab framing with our hanger system

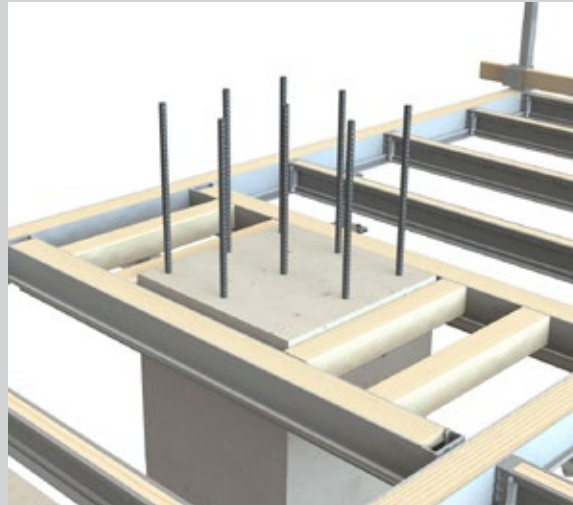

## Simple Filler Conditions

TITAN Filler Beams or 4x4s between main beams



## Beams

Can be installed as independent framing

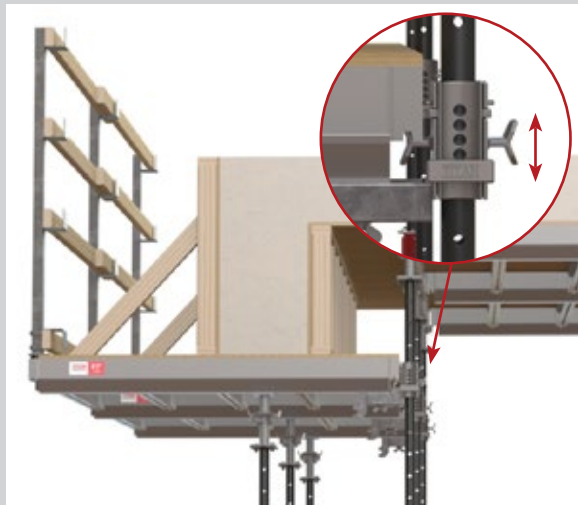

## Beam Bracket

Can be used to incorporate spandrel beam framing into the slab framing



## Slopes

Up to 16% are accommodated with TITAN's 10% Wedge

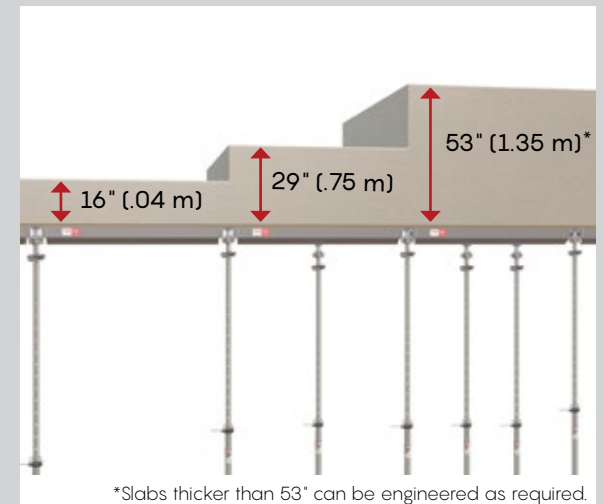

## Thicker Slabs

Can easily be supported with standard framing members



# TITAN

formwork systems

titanformwork.com | 480.305.1900